



ЗА ТРУДОВОМУ ПОДВИГУ

MICRO-DUNE XQ

RECESSED APPLICATIONS

MICRO-DUNE XQ is a super compact in-ground uplighter fitted with seven highly performing white LEDs coupled with ultra spot lenses for an extremely narrow light beam. Its extraordinary luminous efficacy allows to enhance architectural details, such as columns or vertical shafts of large dimensions, with flawless wall grazing effects. **MICRO-DUNE XQ** is available in cold, natural and warm white light versions, as well as in monochrome releases on request, to meet any design specification. Featuring an IP67 weather protection rating and a 3000 kg deadweight load capacity, **MICRO-DUNE XQ** is suitable for ground mounting applications even in vehicular areas.



M I C R O - D U N E X Q

MICRO-DUNE XQ

GRIVEND 

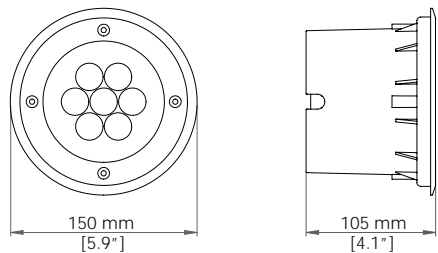

BEAM ANGLE REFERENCE

ULTRA SPOT 4.2°

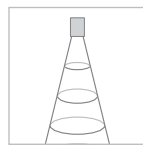

MAX OUTPUT
1147 lm
(US CW configuration)

PHOTOMETRIC DETAILS AVAILABLE ON OUR WEBSITE

FEATURES AND OPTIONS

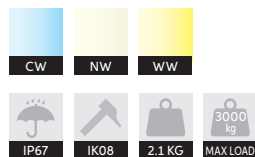

ACCESSORIES



AL8261 ANTIGLARE
(only for monochrome versions)

CODES

AL5219 MICRO-DUNE XQ

OPTICS

US Ultra spot

LED TYPE

CW Cold White 6500K
NW Natural White 4000K
WW Warm White 3000K

TECHNICAL SPECIFICATIONS

MICRO-DUNE XQ is an IP67 ultra compact recessed uplighter, whose die cast aluminium body fitted with stainless steel flange hosts 7 high brightness Cold White, Natural White or Warm White power LEDs. Monochrome LEDs on request. Dimensions: Ø 150/136 mm x 105/100 mm depth. Power supply: 100÷277V / 50-60Hz. Power consumption: 0.06A @ 230VAC / 13.4W per unit. An Electrical Class I appliance, it features an in-built power supply. A 3000 Kg deadweight load capacity makes it suitable for ground mounting applications even in vehicular areas. Operating temperature: -20°C to 40°C (-4°F to 104°F).

